

**GENERAL NOTES:**

**DRIVEWAYS:**  
All existing PCC driveways shall be removed to a point 2.0 ft. from edge of property line and shall be reconstructed according to details as shown on plans. Width of driveways to be reconstructed shall conform to existing width prior to removal.

**SIDEWALKS:**  
Where existing sidewalks are to be removed for new curb construction, it shall be removed to a point 1.75 ft. from back of new curb. Sidewalk removed shall be replaced flush against back of new curb construction.

⊙ = Not in Contract To be used by client

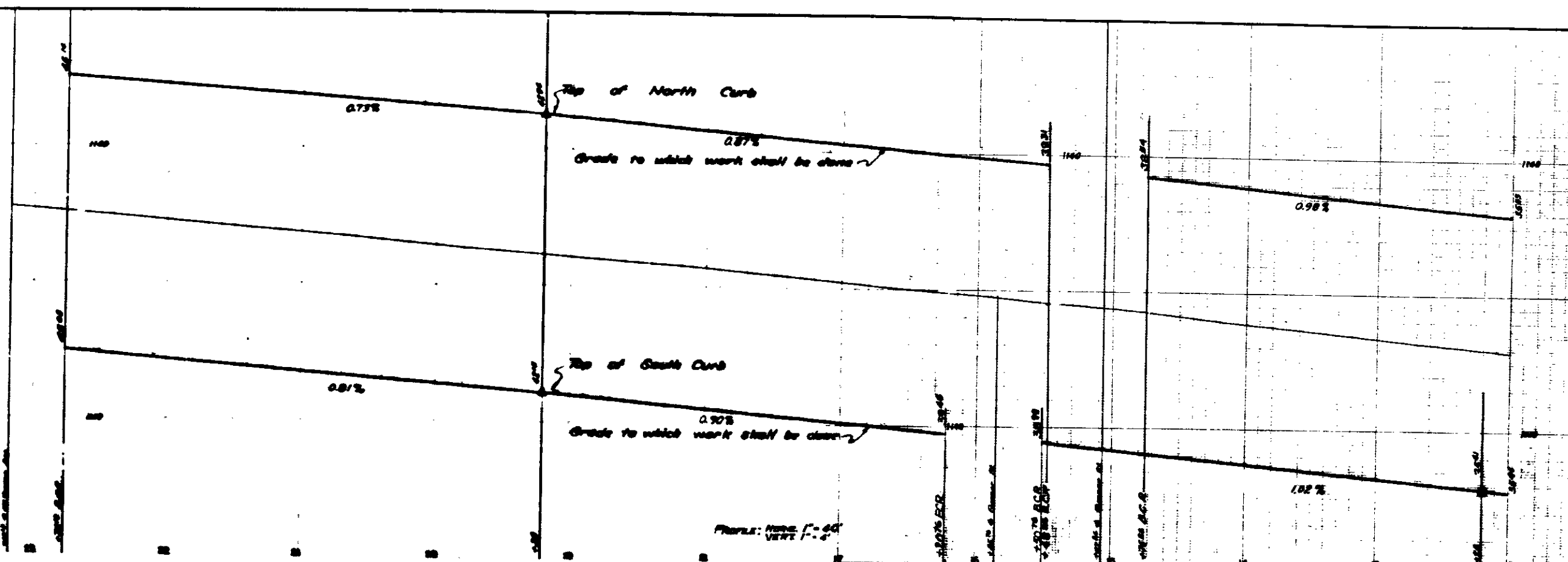

**END OF PROJECT**  
STA. 23+00

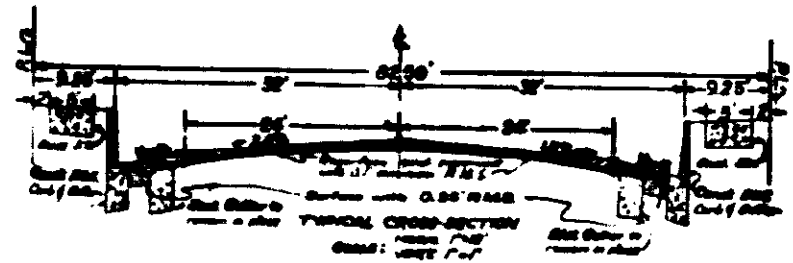

Note: Street Light (⊙) Location as directed by Engineer in Field.

SCALE 1" = 40'

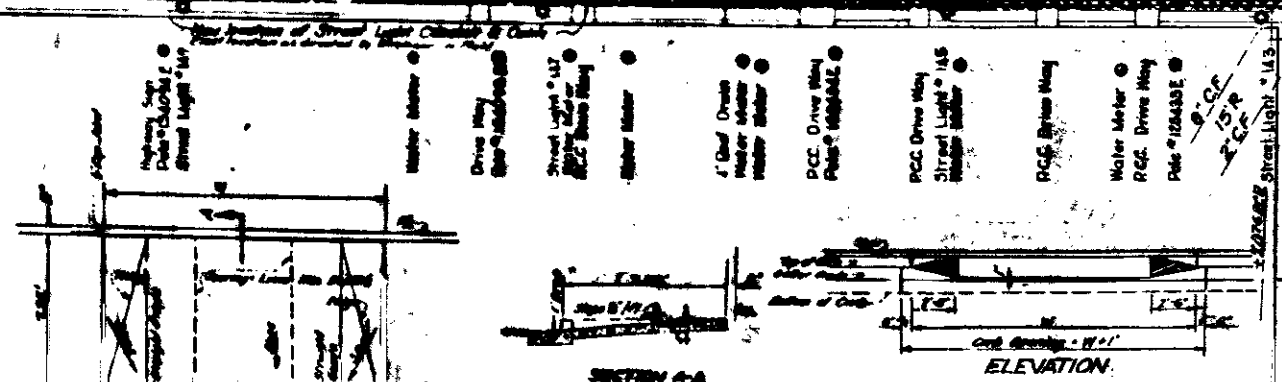

DEPARTMENT OF ENGINEERING  
CITY OF SAN BERNARDINO  
**BASE LINE WIDENING**  
PERRIS ST. to MT. VERNON  
CURB, GUTTER & RESURFACING